

SPECIFICATION CONTROL DRAWING

REV	DESCRIPTION	DWN	DATE	APPROVED
A	ENGINEERING RELEASE	CZS	9/29/99	R. RICE

THIS DRAWING CONTAINS INFORMATION PROPRIETARY TO RF INDUSTRIES, LTD. ANY UNAUTHORIZED USE OF THIS DRAWING IS EXPRESSLY PROHIBITED. ANY VIOLATION IS PUNISHABLE UNDER U.S. COPYRIGHT LAWS.

ALL DIMENSIONS ARE REFERENCE ONLY

008974

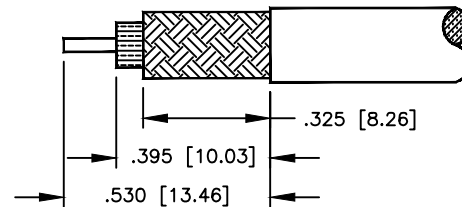
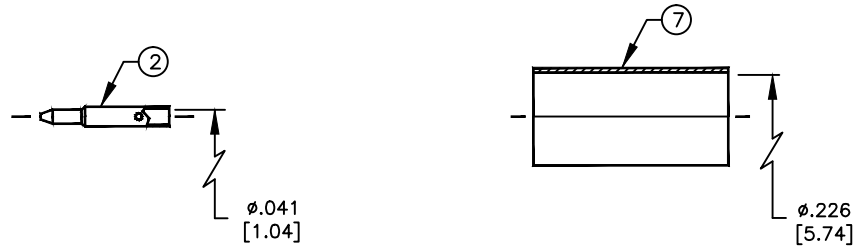
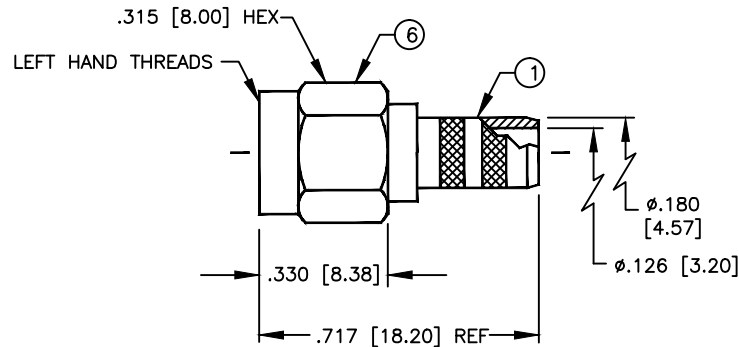

SUGGESTED STRIPPING INSTRUCTIONS

SUGGESTED CRIMP: .213
PIN TO BE SOLDERED OR CRIMPED WITH RFA-4089

SPECIFICATIONS:

IMPEDANCE: 50 OHMS
 WORKING VOLTAGE: 500V PEAK @ SEA LEVEL
 FREQUENCY RANGE: 0-12.4 GHz
 INSERTION LOSS: \leq -.2dB @ 6 GHz
 VSWR MAX: 1.3:1 @ 12 GHz
 FOR RG-55, 55A, 55B, 142, 142A, 142B, 223 & 400/U,
 ALPHA 9055, 9055B, 9223, BELDEN 8219, 83242, 84142, 9907

DIMENSIONS ARE IN INCHES AND [MILLIMETERS]

UNLESS OTHERWISE NOTED TOLERANCES ARE:
 DECIMALS DIAMETER

RF

connectors

DIVISION OF RF INDUSTRIES, LTD.

7610 MIRAMAR RD
 SAN DIEGO, CA 92126
 (858) 549-6340
 (858) 549-6345 FAX

RT-3000-1C1

SMA MALE CRIMP, LEFT HAND THREADS

ITEM	DESCRIPTION	QTY	MATERIAL	FINISH
7	FERRULE	1	COPPER	GOLD
6	SHELL	1	BRASS	GOLD
5	RETAINING RING	1	BeCu	NONE
4	GASKET	1	S.I. RUBBER	RED
3	DIELECTRIC	1	PTFE	NONE
2	PIN	1	BRASS	GOLD
1	BODY	1	BRASS	GOLD

DRAWN C. ZUNIGA	9/29/99
CHECKED	
ORJ DRAWN C. ZUNIGA	9/29/99
APPROVALS	DATE

SIZE A	CABLE GROUP C1	DWG NO. 9247	REV A
SCALE: 2:1		CAD FILE 13ARC B	SHEET 1 OF 1