

# ENVELOPE / ASSEMBLY DRAWING

C08974

SPECIFICATION CONTROL DRAWING		REV	DESCRIPTION	DWN	DATE	APPROVED
THIS DRAWING CONTAINS INFORMATION PROPRIETARY TO RF INDUSTRIES, LTD. ANY UNAUTHORIZED USE OF THIS DRAWING IS EXPRESSLY PROHIBITED. ANY VIOLATION IS PUNISHABLE UNDER U.S. COPYRIGHT LAWS.		A	ENGINEERING RELEASE	WMD	11/11/93	C. JONES
		B	CHC PART # FROM RSA-2373 TO RSA-3271	WMD	1/3/94	C. JONES
		C	CHANGE TERMINATION TO SOLDER PC	KMM	9/7/96	R. RICE

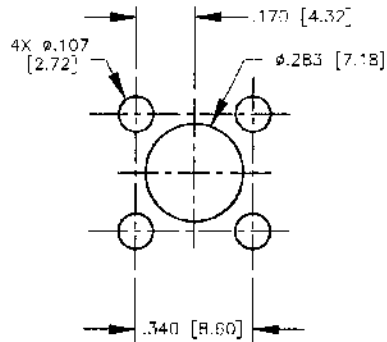

SUGGESTED MOUNTING CONFIGURATION

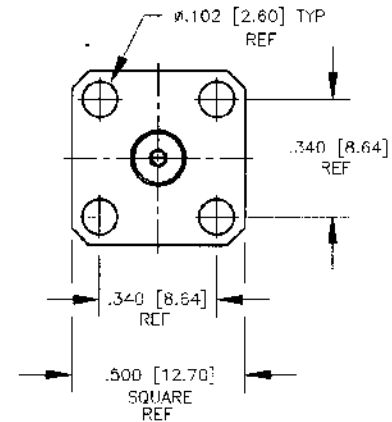
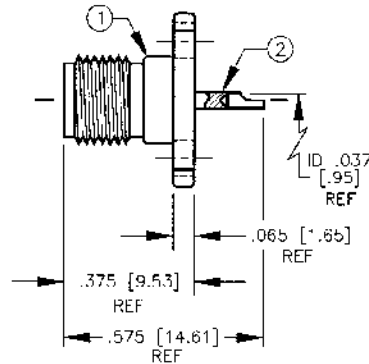

## SPECIFICATIONS:

IMPEDANCE: 50 OHMS  
 WORKING VOLTAGE: 335 VRMS @ SFA 1FVFI  
 FREQUENCY RANGE: 0-12.4 GHz

DIMENSIONS ARE IN INCHES AND [MILLIMETERS]

UNLESS OTHERWISE NOTED TOLERANCES ARE:

DECIMALS DIAMETER

# RF connectors

7615 MIRAMAR RD  
 SAN DIEGO, CA 92126  
 (619) 549-6340  
 (619) 549-6345 FAX

## RSA-3271

SMA FEMALE 4 HOLE FLANG PANEL MOUNT, SOLDER

5	RETAINING RING	1	BRASS	NICKEL
4	DIELECTRIC	1	TEFLON	NONE
3	DIELECTRIC	1	TEFLON	NONE
2	PIN	1	BeCu	GOLD
1	BODY	1	BRASS	NICKEL
ITEM	DESCRIPTION	QTY	MATERIAL	FINISH

DRAWN	K. MAXWELL	9/7/96
CHECKED	<i>R. Rice</i>	<i>aloha</i>
ORJ. DRAWN	K. MAXWELL	11/11/93
APPROVALS	DATE	

SIZE	CABLE GROUP	DWG NO	REV
A	N/A	8250	C

SCALE: 2:1 CAD FILE 13ARC R SHEET 1 OF 1