

# SPECIFICATION CONTROL DRAWING

THIS DRAWING CONTAINS INFORMATION PROPRIETARY TO RF INDUSTRIES, LTD. ANY UNAUTHORIZED USE OF THIS DRAWING IS EXPRESSLY PROHIBITED. ANY VIOLATION IS PUNISHABLE UNDER U.S. COPYRIGHT LAWS.

REV	DESCRIPTION	DWN	DATE	APPROVED
A	ENGINEERING RELEASE	CZS	6/9/99	R. RICE

ALL DIMENSIONS ARE REFERENCE ONLY

008974

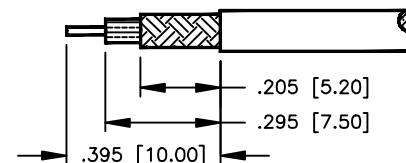
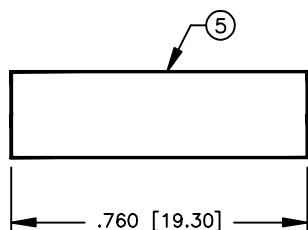
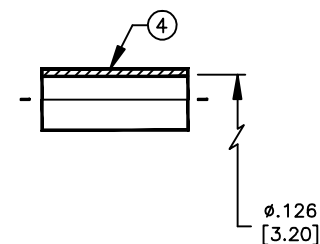
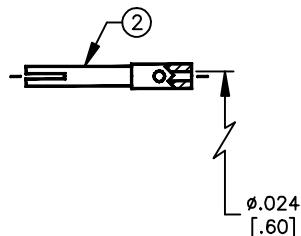
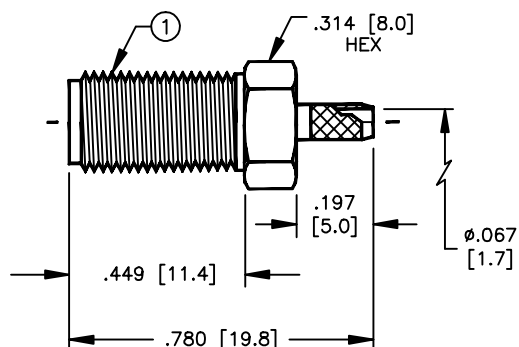

## SUGGESTED STRIPPING INSTRUCTIONS

SUGGESTED CRIMP: .130  
CONTACT TO BE SOLDERED

## SPECIFICATIONS:

IMPEDANCE: 50 OHMS  
WORKING VOLTAGE: 375V PEAK @ SEA LEVEL  
FREQUENCY RANGE: 0-12.4 GHz  
INSERTION LOSS:  $\leq -2$  dB @ 6 GHz  
VSWR MAX: 1.3:1 @ 12 GHz  
FOR RG-316/U DOUBLE SHIELD CABLE

DIMENSIONS ARE IN INCHES  
AND [MILLIMETERS]

UNLESS OTHERWISE NOTED  
TOLERANCES ARE:

DECIMALS DIAMETER

**RF connectors**  
DIVISION OF RF INDUSTRIES, LTD.

7610 MIRAMAR RD  
SAN DIEGO, CA 92126  
(619)549-6340  
(619)549-6345 FAX

# RSA-3050-B1

SMA FEMALE CRIMP

5	TUBING	1	HEAT SHRINK	BLACK	DRAWN	C. ZUNIGA	6/9/99	SIZE	CABLE GROUP	DWG NO.	REV
4	FERRULE [FER-1BKJ]	1	BRASS	NICKEL	CHECKED			A	B1	9194	A
3	DIELECTRIC	1	PTFE	NONE	ORJ DRAWN	C. ZUNIGA	6/9/99	SCALE:	CAD FILE	SHEET	OF
2	CONTACT	1	BeCu	GOLD	APPROVALS	DATE		2:1	13ARC B	1	1
1	BODY	1	BRASS	NICKEL							
ITEM	DESCRIPTION	QTY	MATERIAL	FINISH	APPROVALS	DATE					