

THIS DRAWING CONTAINS INFORMATION PROPRIETARY TO RF INDUSTRIES,
 ANY UNAUTHORIZED USE OF THIS DRAWING IS EXPRESSLY PROHIBITED
 WITHOUT WRITTEN PERMISSION FROM RF INDUSTRIES.
 ANY VIOLATION IS PUNISHABLE UNDER U.S. COPYRIGHT LAWS.

ALL DIMENSIONS ARE REFERENCE ONLY

PART NO.		RP-1202-1B1		
REV	DESCRIPTION	DWN	DATE	APPROVED
-	ENGINEERING RELEASE	CZS	08/31/11	JDMc

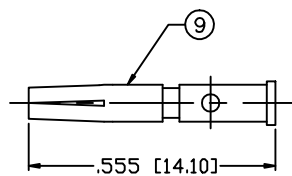
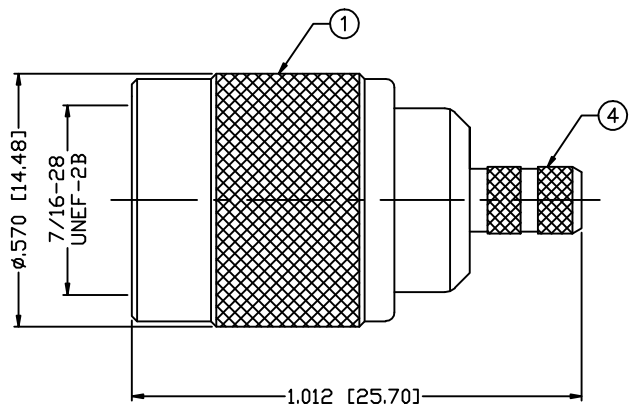

RECOMMENDED CRIMP DIE: .068"

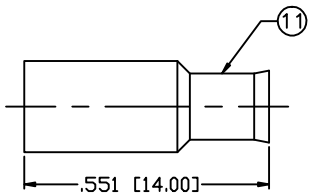
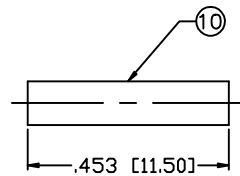

RECOMMENDED CRIMP DIE: .178"

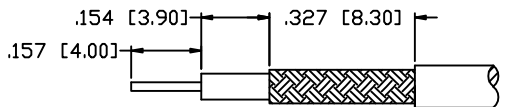

RECOMMENDED STRIPPING DIMENSIONS

SPECIFICATIONS:

IMPEDANCE: 50 Ohms
 FREQUENCY RANGE: 0-7 GHz
 WORKING VOLTAGE: 500 Vrms
 INSULATION RESISTANCE: 5k M ohms min.
 TEMPERATURE RANGE: -65°C TO +85°C
 FOR RG-316/U DOUBLE SHIELD CABLE

1	SHELL	1	BRASS	NICKEL, 100μ"	008974
2	BODY	1	BRASS	NICKEL, 100μ"	
3	INSULATOR	1	PTFE	----	
4	FERRULE STUD	1	BRASS	NICKEL, 100μ"	
5	GASKET	1	RUBBER	----	
6	RETAINING RING	1	BRASS	NICKEL, 100μ"	
7	RING	1	DELTRIN	----	
8	WASHER	1	BRASS	NICKEL, 100μ"	
9	CONTACT	1	BRASS	GOLD, 3μ"	
10	INSERT	1	DELTRIN	----	
11	FERRULE	1	BRASS	NICKEL, 100μ"	
12					
13					
14					

DRAWN	C. ZUNIGA	08/31/11
CHECKED		
ORJ DRAWN	C. ZUNIGA	08/31/11

UNLESS OTHERWISE SPECIFIED:
 1. REMOVE ALL BURRS
 2. BREAK ALL CORNERS & EDGES .005 R. MAX.
 3. CHAMFER 1ST & LAST THREADS 45°
 4. SURFACE ROUGHNESS 63 FINISH MIL-STD-10
 5. DIAMETERS ON COMMON CENTERS TO BE CONCENTRIC WITHIN .002 T.I.R.
 6. ALL DIMENSIONS ARE AFTER PLATING.

DIMENSIONS ARE IN INCHES AND [MILLIMETERS]
 UNLESS OTHERWISE NOTED TOLERANCES ARE:
 DECIMALS .xxx±.003 [.08]
 .xx±.005 [.13]
 DIAMETER .xxx±.001 [.03]
 .xx±.003 [.08]

RF connectors
 DIVISION OF RF INDUSTRIES, LTD.
 7610 MIRAMAR RD
 SAN DIEGO, CA 92126
 (858) 549-6340
 (858) 549-6345 FAX

TNC PLUG, CRIMP			
REVERSE POLARITY			
SIZE	CABLE GROUP	DWG NO.	REV
A	B1	RP-1202-1B1	-
SCALE:	NTS	CAD FILE	OUTLINE
		SHEET 1 OF 1	