

PART NO.

**RFD-1605-2-X**

REV	DESCRIPTION	DWN	DATE	APPROVED
A	CHANGED FERRULE STUD & UPDATED DWG FORMAT	CZS	03/12/15	JDMc

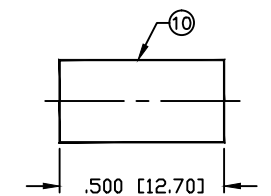
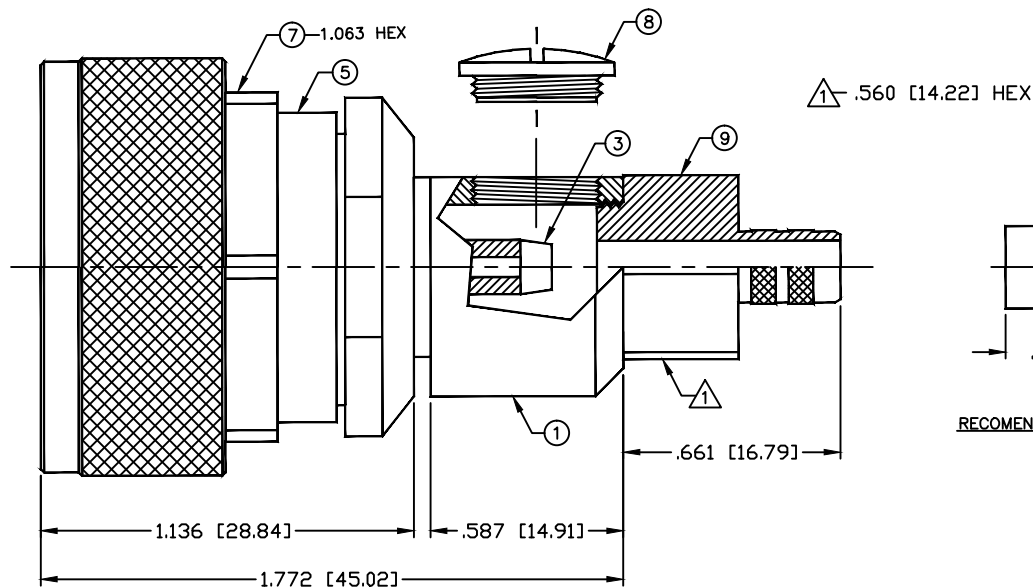

RECOMENDED CRIMP DIE: .255"

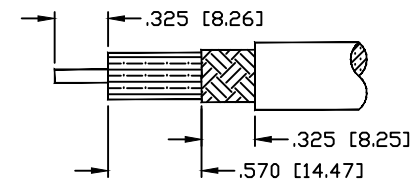

SUGGESTED STRIPPING INSTRUCTIONS [STRAIGHT]

NTS

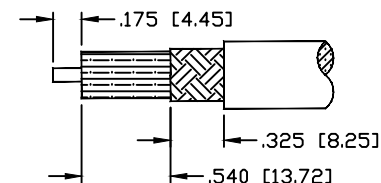

SUGGESTED STRIPPING INSTRUCTIONS [R/ANGLE]

NTS

**SPECIFICATIONS:**

IMPEDANCE: 50 Ohms

FREQUENCY RANGE: 0-7.5 GHz

PEAK POWER: 13.2 Kw max.

AVERAGE POWER: 3.0 Kw max.

TEMPERATURE RANGE: -55°C TO 150°C

FOR RG-8/X, BELDEN 9258, MAXRAD MBX-100 &amp;

MBX-1000, MICRO 8/U, REMEE 1600, SAXTON 8315 &amp;

TIMES LMR-240 &amp; LMR-240 ULTRAFLEX CABLE

1	BODY	1	BRASS	SILVER, 80 $\mu$ "
2	PIN	1	BRASS	SILVER, 80 $\mu$ "
3	CONTACT	1	BRASS	SILVER, 80 $\mu$ "
4	INSULATOR	1	PTFE	---
5	GROUND RING	1	BRASS	SILVER, 80 $\mu$ "
6	GASKET	1	RUBBER	---
7	SHELL	1	BRASS	SILVER, 80 $\mu$ "
8	SCREW CAP	1	BRASS	SILVER, 80 $\mu$ "
9	BACK NUT	1	BRASS	SILVER, 80 $\mu$ "
10	FERRULE	1	BRASS	SILVER, 80 $\mu$ "

#	DESCRIPTION	QTY	MATERIAL	FINISH
---	-------------	-----	----------	--------

CUSTOMER  
OUTLINE DRAWINGALL DIMENSIONS  
ARE REFERENCE ONLYUNLESS OTHERWISE SPECIFIED:  
DIMENSIONS ARE IN INCHES  
AND [MILLIMETERS]DRAWN  
C. ZUNIGA 03/12/15  
CHECKEDORJ DRAWN  
C. ZUNIGA 05/08/03**RoHS  
COMPLIANT**PROPRIETARY AND CONFIDENTIAL  
THIS DRAWING CONTAINS  
INFORMATION PROPRIETARY TO  
RF INDUSTRIES. ANY  
UNAUTHORIZED USE OF THIS  
DRAWING IS EXPRESSLY  
PROHIBITED WITHOUT WRITTEN  
PERMISSION FROM RF  
INDUSTRIES. ANY VIOLATION IS  
PUNISHABLE UNDER U.S.  
COPYRIGHT LAWS.**RFconnectors**7610 MIRAMAR RD.  
SAN DIEGO, CA 92126  
(858) 549-6340  
DIVISION OF RF INDUSTRIES, LTD. (858) 549-6345 FAX**7/16 DIN PLUG CRIMP**

STRAIGHT / RIGHT ANGLE COMBO

SIZE	CABLE GROUP	DWG NO.	REV
A	X	<b>RFD-1605-2-X</b>	A
SCALE:	ENGINEERING ID:	000000	SHEET 1 OF 1
NTS			