

SPECIFICATION CONTROL DRAWING

THIS DRAWING CONTAINS INFORMATION PROPRIETARY TO RF INDUSTRIES, LTD. ANY UNAUTHORIZED USE OF THIS DRAWING IS EXPRESSLY PROHIBITED. ANY VIOLATION IS PUNISHABLE UNDER U.S. COPYRIGHT LAWS.

| REV | DESCRIPTION | DWN | DATE | APPROVED |
|-----|---|-----|---------|------------|
| G1 | UPDATE DRAWING REPLACES DWG. #7931 | -- | 4/16/93 | J. BENZ |
| H | CHG SMA CONTACT | DM | 7/30/93 | K.HARTMANN |
| J | CHANGE DIMENSION | KMM | 9/14/93 | KWH |
| K | CHG CON MATERIAL & DIM / CHG BODY & DIE DIM TO STDIZE | CZS | 9/22/98 | R. RICE |

000000

ALL DIMENSIONS ARE REFERENCE ONLY

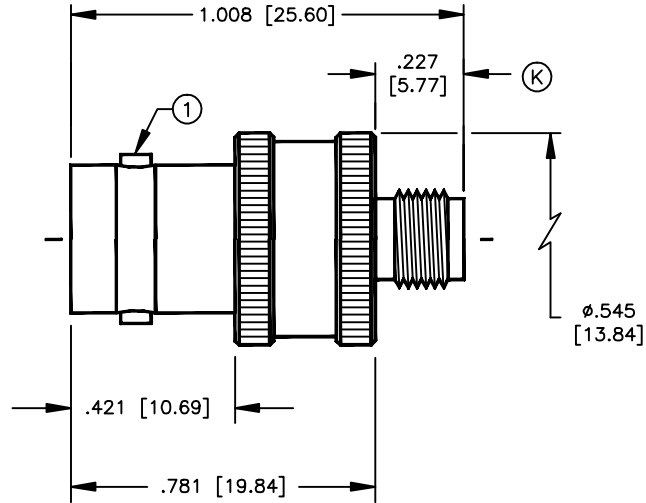

SPECIFICATIONS:

IMPEDANCE: 50 OHMS
 WORKING VOLTAGE: 335 VRMS @ SEA LEVEL
 FREQUENCY RANGE: 0-4 GHz
 INTERFACE PER MIL-STD-348A, SECTION 301.2

DIMENSIONS ARE IN INCHES AND [MILLIMETERS]

UNLESS OTHERWISE NOTED TOLERANCES ARE:
 DECIMALS DIAMETER

RF connectors
 DIVISION OF RF INDUSTRIES, LTD.

7610 MIRAMAR RD
 SAN DIEGO, CA 92126
 (619)549-6340
 (619)549-6345 FAX

RFB-1142-4

BNC FEMALE TO MOTOROLA SMA FEMALE ADAPTER

| ITEM | DESCRIPTION | QTY | MATERIAL | FINISH | APPROVALS | DATE |
|------|----------------|-----|-------------|--------|------------|---------|
| 4 | RETAINING RING | 1 | BRASS | NICKEL | C. ZUNIGA | 9/22/98 |
| 3 | DIELECTRIC | 1 | PTFE | NONE | CHECKED | |
| 2 | CONTACT | 1 | PHOS BRONZE | GOLD | ORJ DRAWN | |
| 1 | BODY | 1 | BRASS | NICKEL | D. BRUMLEY | 4/18/91 |

| SIZE | CABLE GROUP | DWG NO. | REV |
|------|-------------|---------|-----|
| A | N/A | 8089 | K |

SCALE: 2:1 CAD FILE 13ARC B SHEET 1 OF 1