

CABLE ASSEMBLY INSTRUCTIONS

RFN-1000-1S

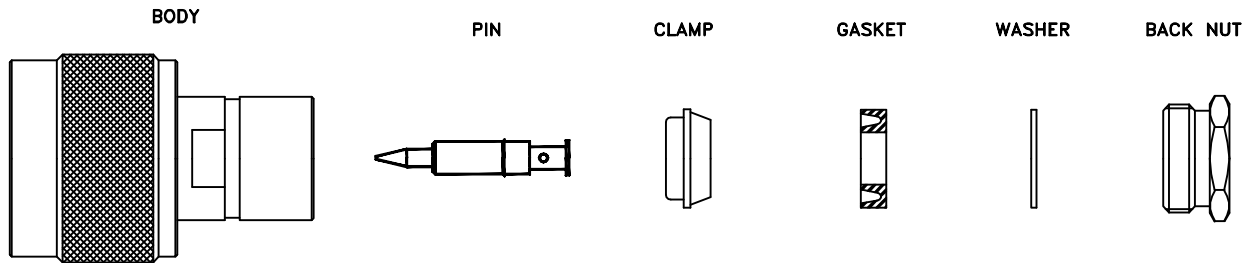

STEP 1

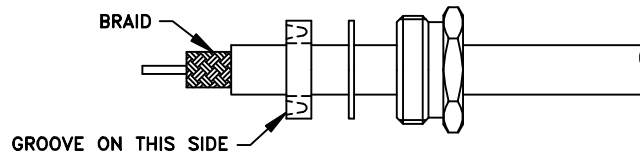

STEP 2

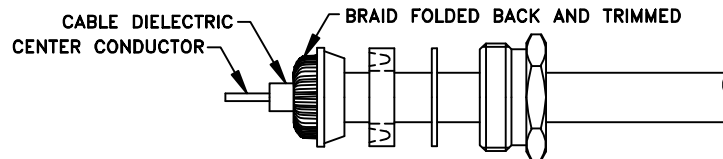

STEP 3

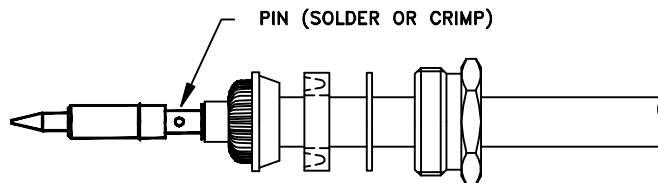

STEP 4

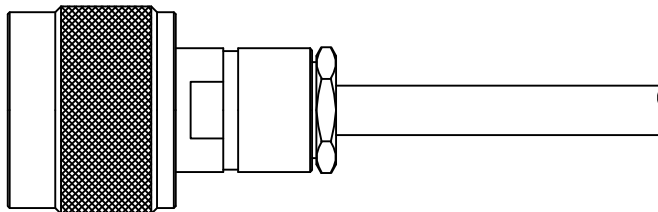

- Step 1: Cut end of cable evenly. Strip cable to dimensions shown on outline drawing. All cuts are to be clean and square. Do not nick braid, dielectric or center conductor. Slide back nut, washer and gasket onto cable. Braid must be combed for assembly of clamp.
- Step 2: Place the clamp over braid and push clamp back against cable jacket. Fold back braid wire and form over the clamp evenly. Trim any extra braid extending over clamp.
- Step 3: Slide pin onto center conductor until it yields against the cable dielectric. Pre tin cable conductor if using stranded cable (if needed). Solder or crimp pin in place.
- Step 4: Properly seat groove of gasket onto clamp. Insert pin, cable and hardware into the body while holding the cable only until the pin snaps in place. Then tighten back nut into the body while holding the body stationary.

RFN-1000-1S AP.DWG

RF CONNECTORS

1/29/13

7610 Miramar Road, San Diego, CA 92126-4202 - (858) 549-6340
(800) 233-1728 - Fax (858) 549-6345 E-mail: rfi@rfindustries.com - www.rfindustries.com

jdm