

2 Watt Dummy Load 4.3-10 Male, DC-6GHz

RFDL-2W-43M

Low VSWR

Other Configurations Available

50 Ohms Impedance

RoHS Compliant

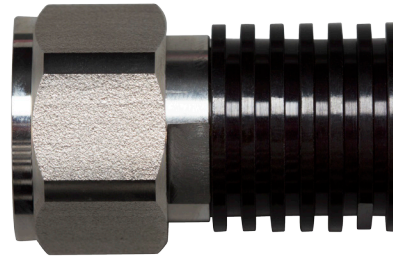

GENERAL SPECIFICATIONS

Device Type Dummy Termination Load
Interface 4.3-10 Male

ELECTRICAL SPECIFICATIONS

Frequency DC-6GHz
Average Power 2Watt
Impedance 50Ω
VSWR ≤ 1.08 at 3GHz, ≤ 1.20 at 6GHz

MECHANICAL SPECIFICATIONS

Inner Contact Plating Silver
Outer Plating White Bronze / Brass (Tri-Metal)
Heat Sink Plating Aluminum (Black Anodized)

ENVIRONMENTAL SPECIFICATIONS

Application Indoor
Operating Temperature -35°C ~ +125°C; -31°F ~ +257°F
Relative Humidity Up to 95%

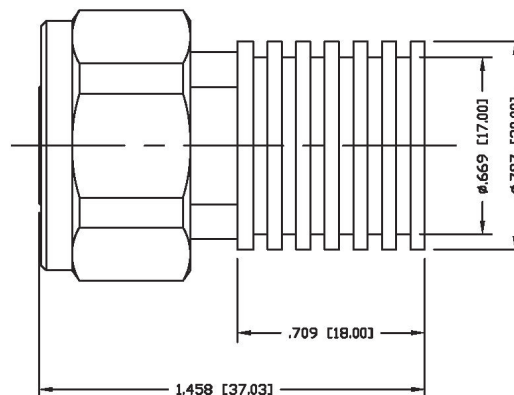

RF Industries

(NASDAQ: RFIIL)

7610 Miramar Road
San Diego, CA 92126
(800) 233-1728
(858) 549-6340
Fax: (858) 549-6345
rfi@rfindustries.com
www.rfindustries.com