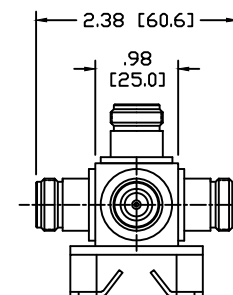
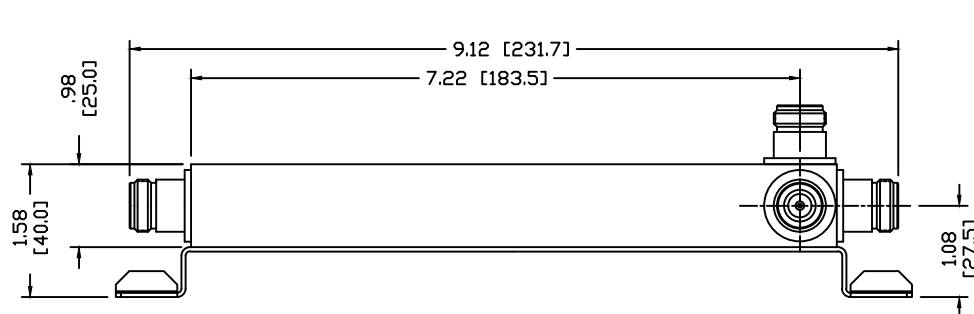
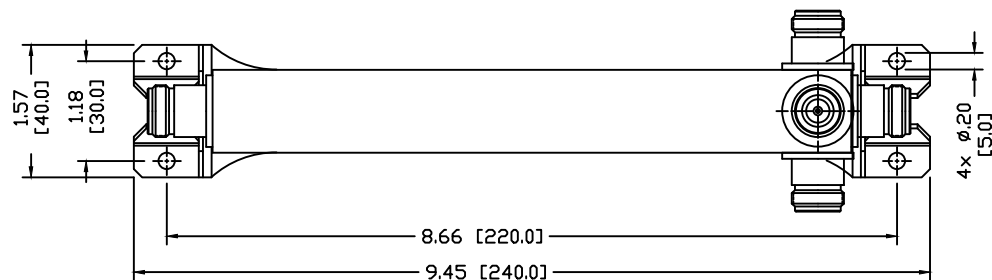

PART NO.

RFPS-4C-NF

REV	DESCRIPTION	DWN	DATE	APPROVED
-	ENGINEERING RELEASE	CZS	03/04/16	JDMc

**SPECIFICATIONS:**

IMPEDANCE: 50 Ohms

OPERATION FREQUENCY BAND: 698-2700 MHz

3RD INTERMODULATION: ≤ -155 dBc (RELATIVE TO CARRIER)

3RD INTERMODULATION TEST METHOD: TWO+43dBm CARRIERS

MAXIMUM AVERAGE POWER: 350 WATT

INSERTION LOSS AT FREQUENCY BAND: <0.2 dB@698-2700MHz

POWER PEAK (W) MAX: 1.5Kw

SPLIT LOSS: 6dB

VSWR: ≤ 1.25

INNER CONTACT PLATING: SILVER

OUTER PLATING: WHITE BRONZE

OPERATION TEMPERATURE: $-30^{\circ}\text{C} \sim +75^{\circ}\text{C}$

RELATIVE HUMIDITY: UP TO 100%

APPLICATION: INDOOR/OUTDOOR

REGULATORY COMPLIANCE/CERTIFICATIONS: RoHS/IP67

CUSTOMER
OUTLINE DRAWINGALL DIMENSIONS
ARE REFERENCE ONLYUNLESS OTHERWISE SPECIFIED:
DIMENSIONS ARE IN INCHES
AND [MILLIMETERS]

DRAWN	C. ZUNIGA	03/04/16
CHECKED		

ORJ DRAWN	C. ZUNIGA	03/04/16
-----------	-----------	----------

**RoHS
COMPLIANT**

PROPRIETARY AND CONFIDENTIAL
THIS DRAWING CONTAINS
INFORMATION PROPRIETARY TO
RF INDUSTRIES. ANY
UNAUTHORIZED USE OF THIS
DRAWING IS EXPRESSLY
PROHIBITED WITHOUT WRITTEN
PERMISSION FROM RF
INDUSTRIES. ANY VIOLATION IS
PUNISHABLE UNDER U.S.
COPYRIGHT LAWS.

RFconnectors7610 MIRAMAR RD.
SAN DIEGO, CA 92126
(858) 549-6340
(858) 549-6345 FAX**N FEMALE POWER SPLITTER**

FOUR WAY - 698-2700MHz

SIZE	CABLE GROUP	DWG NO.	REV
A		RFPS-4C-NF	-
SCALE:	ENGINEERING ID:	000000	SHEET 1 OF 1
NTS			