

THIS DRAWING CONTAINS INFORMATION PROPRIETARY TO RF INDUSTRIES,  
 ANY UNAUTHORIZED USE OF THIS DRAWING IS EXPRESSLY PROHIBITED  
 WITHOUT WRITTEN PERMISSION FROM RF INDUSTRIES.  
 ANY VIOLATION IS PUNISHABLE UNDER U.S. COPYRIGHT LAWS.

PART NO.

# RFN-1009-I-99

REV	DESCRIPTION	DWN	DATE	APPROVED
-	ENGINEERING RELEASE	CZS	4/20/05	JDMc
A	UPDATED CABLE GROUP LIST	CZS	08/08/06	JDMc

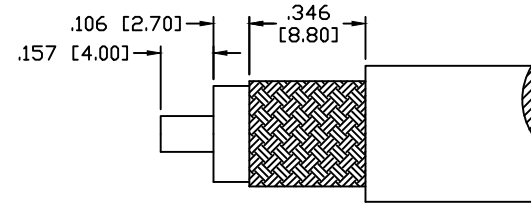
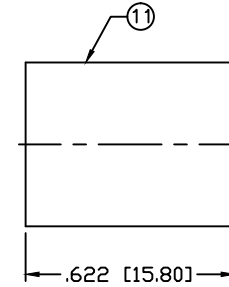
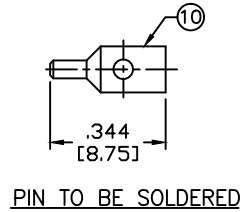
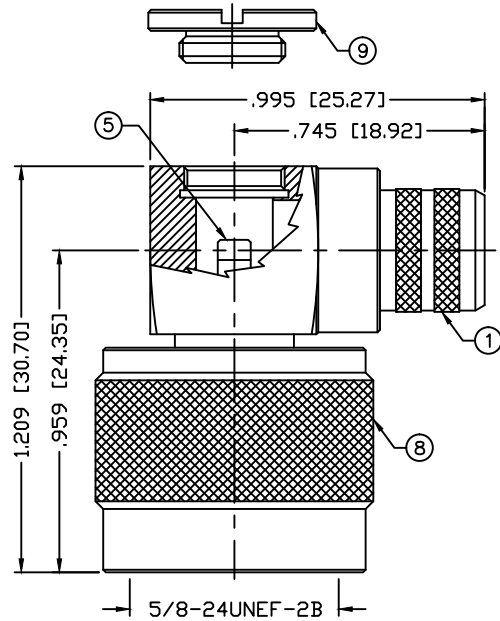

## SPECIFICATIONS:

IMPEDANCE: 50 Ohms  
 FREQUENCY RANGE: 0-11 GHz  
 VSWR: 1.5 Max. @ 9 GHz  
 INSERTION LOSS: .06 dB Max.  $\times \sqrt{f}$  GHz  
 WORKING VOLTAGE: 1k V rms @ sea level  
 TEMPERATURE RANGE: -65°C TO 85°C  
 INSULATION RESISTANCE: 5k M Ohms min.  
 FOR BELDEN 8214, 9913, 9913F, 9914, CAROL C1180,  
 TIMES AA-5886 & LMR-400 CABLE

NOTE: ATTACH CABLE TO CONNECTOR BY  
 SOLDERING THE CABLE INNER CONDUCTOR  
 TO THE PIN SLOT INSIDE THE CONNECTOR

ALL DIMENSIONS ARE REFERENCE ONLY

1	BODY	1	BRASS	WHITE BRONZE, 80 $\mu$ "	008974	
2	PRESS BODY	1	BRASS	WHITE BRONZE, 80 $\mu$ "		
3	INSULATOR	1	PTFE	----		
4	GROUND RING	1	BRASS	WHITE BRONZE, 80 $\mu$ "		
5	PIN	1	BRASS	GOLD, 30 $\mu$ "		
6	RETAINING RING	1	SST	----		
7	GASKET	1	SILICONE	----		
8	SHELL	1	BRASS	WHITE BRONZE, 80 $\mu$ "		
9	SCREW CAP	1	BRASS	WHITE BRONZE, 80 $\mu$ "		
10	PIN	1	BRASS	GOLD, 30 $\mu$ "		
11	FERRULE	1	BRASS	WHITE BRONZE, 80 $\mu$ "		
12						
13						
14						
#	DESCRIPTION	QTY	MATERIAL	FINISH	APPROVALS	DATE

UNLESS OTHERWISE SPECIFIED:

DIMENSIONS ARE IN INCHES  
 AND [MILLIMETERS]  
 UNLESS OTHERWISE NOTED  
 TOLERANCES ARE:  
 DECIMALS      DIAMETER

# RF connectors

7610 MIRAMAR RD  
 SAN DIEGO, CA 92126  
 (858) 549-6340  
 (858) 549-6345 FAX

## N PLUG, CRIMP

RIGHT ANGLE

SIZE	CABLE GROUP	DWG NO.	REV
A		<b>RFN-1009-I-99</b>	A
SCALE:	NTS	CAD FILE	OUTLINE
		SHEET	1 OF 1