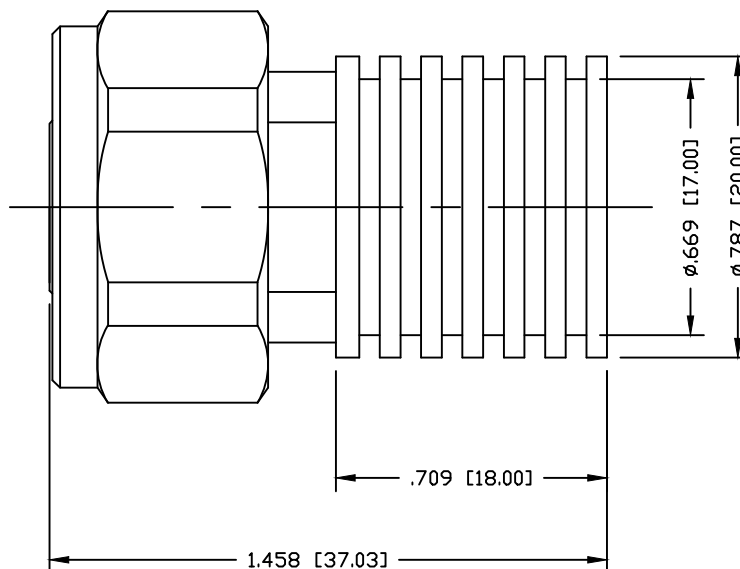

PART NO.

**RFDL-2W-43M**

REV	DESCRIPTION	DWN	DATE	APPROVED
-	ENGINEERING RELEASE	CZS	06/16/16	JDMc

SPECIFICATIONS:

IMPEDANCE: 50 Ohms  
 OPERATION FREQUENCY BAND: DC-6GHz  
 POWER RATED(WATTS): 2W  
 VSWR:  $\leq 1.08$  AT 3GHz,  $\leq 1.20$  AT 6GHz  
 RELATIVE HUMIDITY: 0-95%  
 OPERATION TEMPERATURE:  $-35^{\circ}\text{C} \sim +125^{\circ}\text{C}$

CUSTOMER  
OUTLINE DRAWINGALL DIMENSIONS  
ARE REFERENCE ONLYUNLESS OTHERWISE SPECIFIED:  
DIMENSIONS ARE IN INCHES  
AND [MILLIMETERS]

DRAWN	C. ZUNIGA	06/16/16
CHECKED		
ORJ DRAWN	C. ZUNIGA	06/16/16

**RoHS  
COMPLIANT**

PROPRIETARY AND CONFIDENTIAL  
 THIS DRAWING CONTAINS  
 INFORMATION PROPRIETARY TO  
 RF INDUSTRIES. ANY  
 UNAUTHORIZED USE OF THIS  
 DRAWING IS EXPRESSLY  
 PROHIBITED WITHOUT WRITTEN  
 PERMISSION FROM RF  
 INDUSTRIES. ANY VIOLATION IS  
 PUNISHABLE UNDER U.S.  
 COPYRIGHT LAWS.

**RFconnectors**

7610 MIRAMAR RD.  
 SAN DIEGO, CA 92126  
 (858) 549-6340  
 (858) 549-6345 FAX

DIVISION OF RF INDUSTRIES, LTD.

## 4.3-10 MALE 2 WATT DUMMY LOAD

SIZE	CABLE GROUP	DWG NO.	REV
A	N/A	<b>RFDL-2W-43M</b>	—
SCALE:	ENGINEERING ID:	SHEET 1 OF 1	
NTS	000000		