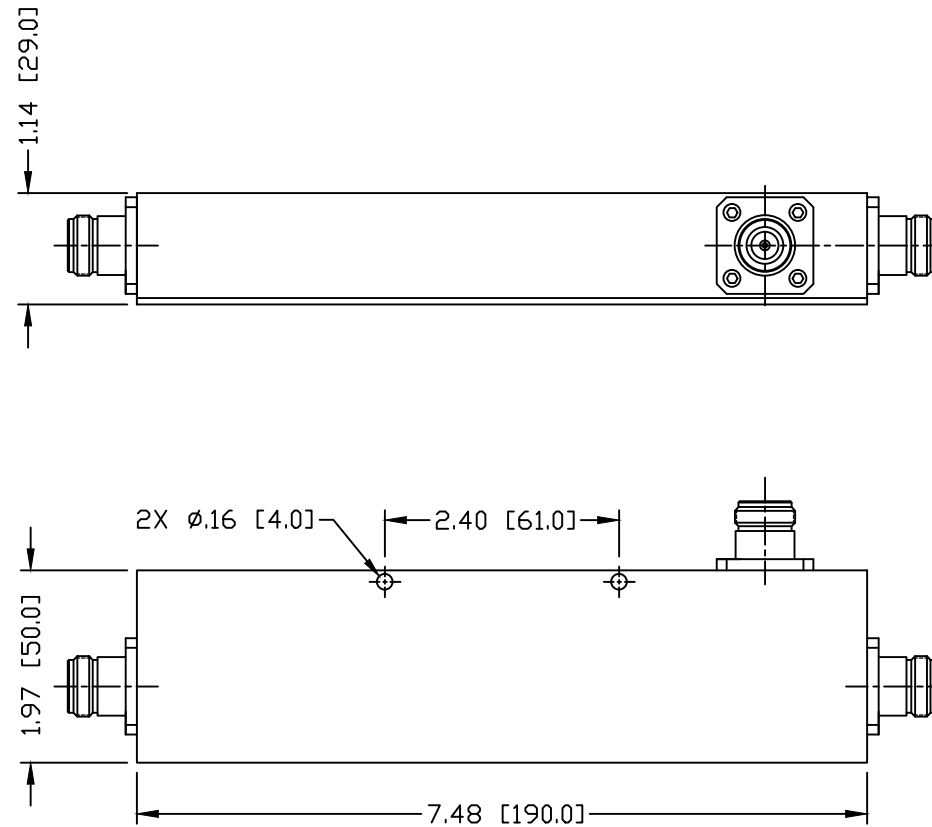

PART NO.

**RFDC-8DBA-NF**

REV	DESCRIPTION	DWN	DATE	APPROVED
-	ENGINEERING RELEASE	CZS	11/11/19	JDMc

SPECIFICATIONS:

IMPEDANCE: 50 Ohms  
 OPERATION FREQUENCY BAND: 380-2700 MHz  
 3RD INTERMODULATION:  $\leq -155$  dBc (RELATIVE TO CARRIER)  
 3RD INTERMODULATION TEST METHOD: 2x43dBm CARRIERS  
 AVERAGE POWER: 300W  
 INSERTION LOSS:  $\leq 1.55$  dB  
 COUPLING: 8dB  
 COUPLING TOLERANCE:  $\pm 1.3$  dB  
 ISOLATION:  $\geq 25$  dB  
 VSWR:  $\leq 1.3$   
 INNER CONTACT PLATING: SILVER  
 OUTER PLATING: WHITE BRONZE  
 OPERATION TEMPERATURE:  $-30^{\circ}\text{C} \sim +75^{\circ}\text{C}$   
 APPLICATION: OUTDOOR  
 REGULATORY COMPLIANCE/CERTIFICATIONS: RoHS/IP67

CUSTOMER  
OUTLINE DRAWINGALL DIMENSIONS  
ARE REFERENCE ONLY
 UNLESS OTHERWISE SPECIFIED:  
 DIMENSIONS ARE IN INCHES  
 AND [MILLIMETERS]

DRAWN	11/11/19
C. ZUNIGA	
CHECKED	
ORJ DRAWN	11/11/19
C. ZUNIGA	

**RoHS**  
**COMPLIANT**

 PROPRIETARY AND CONFIDENTIAL  
 THIS DRAWING CONTAINS  
 INFORMATION PROPRIETARY TO  
 RF INDUSTRIES. ANY  
 UNAUTHORIZED USE OF THIS  
 DRAWING IS EXPRESSLY  
 PROHIBITED WITHOUT WRITTEN  
 PERMISSION FROM RF  
 INDUSTRIES. ANY VIOLATION IS  
 PUNISHABLE UNDER U.S.  
 COPYRIGHT LAWS.

**RFconnectors**  
 DIVISION OF RF INDUSTRIES, LTD.

 7610 MIRAMAR RD.  
 SAN DIEGO, CA 92126  
 (858) 549-6340  
 (858) 549-6345 FAX

**8 dB DIRECTIONAL COUPLER**  
**N FEMALE - 380-2700 MHz**

SIZE	CABLE GROUP	DWG NO.	REVISION
A		<b>RFDC-8DBA-NF</b>	—
SCALE:	ENGINEERING ID:	SHEET 1 OF 1	
NTS	2000010		