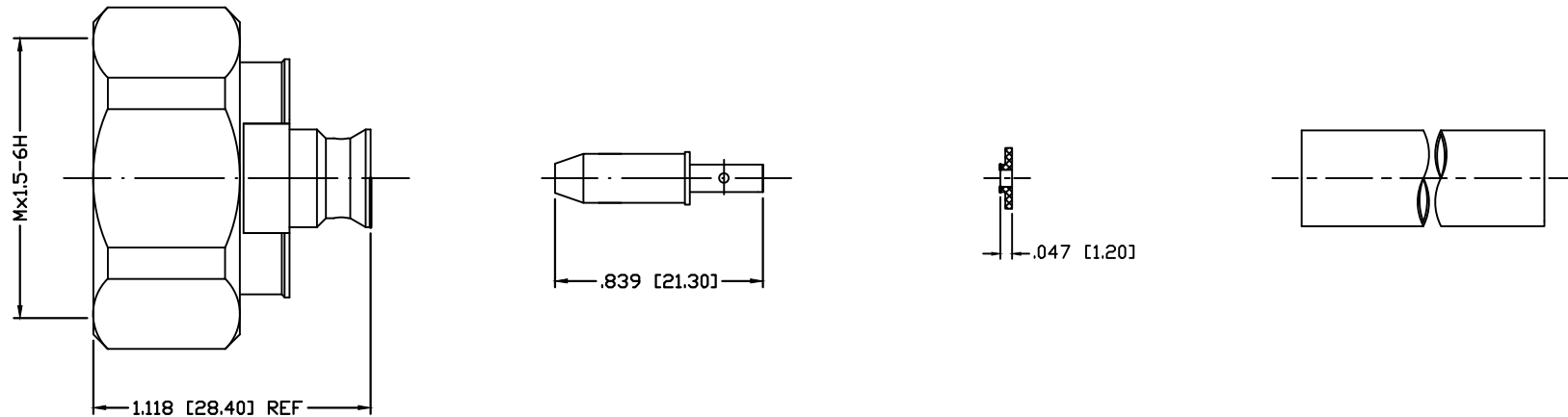

PART NO.

**RFD-1601-HPL**

REV	DESCRIPTION	DWN	DATE	APPROVED
A	CHANGE DIMENSIONS THROUGHOUT / ADD TUBING	CZS	09/11/15	JDMc

**SPECIFICATIONS:**

IMPEDANCE: 50 OHMS  
 FREQUENCY RANGE: DC-7.5 GHz  
 INSERTION LOSS: -.01 dB x  $\sqrt{\text{FREQUENCY GHz}}$   
 VSWR MAX: <1.15:1 @ 3 GHz  
 3rd ORDER IM:  $\leq -155$  dBc

8	TUBING	HEAT SHRINK	2	---	---
7	SHELL	012-16M0001BE	2	BRASS	SILVER
6	O-RING	GSO-211	2	S.I. RUBBER	---
5	GROUND RING	014-16M0001BE	2	BRASS	SILVER
4	INSULATOR	010-16X0001TX	2	PTFE	---
3	CONTACT SHAFT	013-16X0009BE	1	BRASS	SILVER
2	PIN	009-16M0001BE	2	BRASS	SILVER
1	BODY	001-16X0004BE	1	BRASS	SILVER
#	DESCRIPTION	PART NUMBER	QTY	MATERIAL	FINISH

CUSTOMER  
OUTLINE DRAWINGALL DIMENSIONS  
ARE REFERENCE ONLYUNLESS OTHERWISE SPECIFIED:  
DIMENSIONS ARE IN INCHES  
AND [MILLIMETERS]

DRAWN	C. ZUNIGA	09/11/15
CHECKED		
ORJ DRAWN	C. ZUNIGA	02/20/14

**RoHS**  
**COMPLIANT**

PROPRIETARY AND CONFIDENTIAL  
THIS DRAWING CONTAINS  
INFORMATION PROPRIETARY TO  
RF INDUSTRIES. ANY  
UNAUTHORIZED USE OF THIS  
DRAWING IS EXPRESSLY  
PROHIBITED WITHOUT WRITTEN  
PERMISSION FROM RF  
INDUSTRIES. ANY VIOLATION IS  
PUNISHABLE UNDER U.S.  
COPYRIGHT LAWS.

**RFconnectors**  
DIVISION OF RF INDUSTRIES, LTD. (858) 549-6345 FAX

7610 MIRAMAR RD.  
SAN DIEGO, CA 92126  
(858) 549-6340

**7/16 DIN PLUG  
FOR SPP250**

SIZE	CABLE GROUP	DWG NO.	REV
A	N/A	<b>RFD-1601-HPL</b>	A
SCALE:	ENGINEERING ID:	SHEET 1 OF 1	
NTS	000000		