

PART NO.		<b>PT-4000-141LP</b>	
REV	DESCRIPTION	DWN	DATE
A	PART NUMBER CHANGED	CZS	01/10/17
			APPROVED
			JDMc

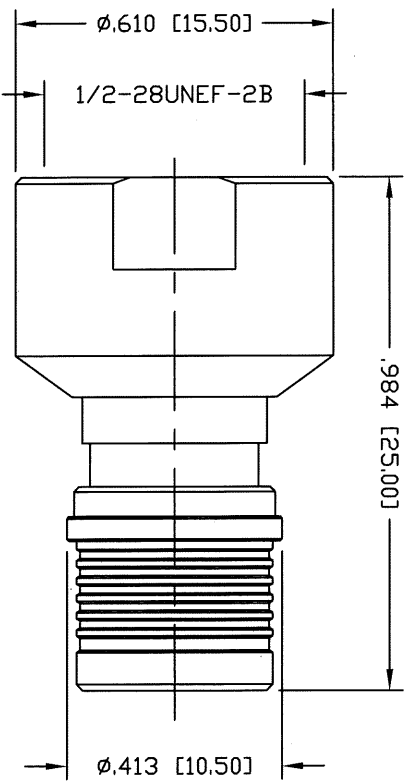

**SPECIFICATIONS:**

IMPEDANCE: 50 Ohms  
 FREQUENCY RANGE: 0-3 GHz  
 VSWR: <1.15  
 DIELECTRIC WITHSTANDING VOLTAGE: 750V/AC  
 INSULATION RESISTANCE: 5K M Ohms  
 TEMPERATURE RANGE: -40°C TO 155°C  
 MECHANICAL DURABILITY: 500 CYCLES

#	DESCRIPTION	QTY	MATERIAL	FINISH
5	COUPLING NUT	1	BRASS	WHITE BRONZE
4	GROUND RING	1	PHOS BRONZE	WHITE BRONZE
3	CONTACT	1	BeCu	SILVER
2	INSULATOR	1	PTFE	---
1	BODY	1	BRASS	WHITE BRONZE

CUSTOMER OUTLINE DRAWING		UNLESS OTHERWISE SPECIFIED: DIMENSIONS ARE IN INCHES AND [MILLIMETERS]	
ALL DIMENSIONS ARE REFERENCE ONLY		DRAWN C. ZUNIGA	
CHECKED <i>[Signature]</i>		DATE 01/10/17	
C. ZUNIGA		06/09/16	

**ROHS COMPLIANT**

PROPRIETARY AND CONFIDENTIAL  
 THIS DRAWING CONTAINS  
 INFORMATION PROPRIETARY TO  
 RF INDUSTRIES. ANY  
 UNAUTHORIZED USE OF THIS  
 DRAWING IS EXPRESSLY  
 PROHIBITED. IT HEREBY  
 REPRESENTS AN ACCEPTED  
 INDUSTRY STANDARD. ALL RIGHTS  
 RESERVED UNDER U.S.  
 COPYRIGHT LAWS.

**RF Connectors**  
 DIVISION OF RF INDUSTRIES, LTD. (858) 549-6345 FAX

7610 MIRAMAR RD.  
 SAN DIEGO, CA 92126  
 (858) 549-6340

**UNDAPT TO QMA PLUG  
 ADAPTER**

SIZE	CABLE GROUP	DWG NO.	REV
A	N/A	PT-4000-141LP	A
SCALE:	ENGINEERING ID:	000000	SHEET 1 OF 1