

RFD-4195-SR2FL

REV	DESCRIPTION	DATE	APPR
-	ENGINEERING RELEASE	10/02/14	JDM

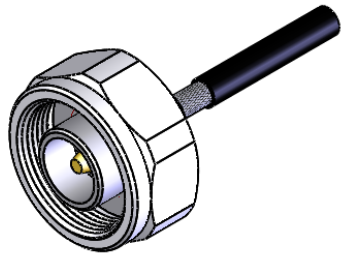

ASSEMBLY INSTRUCTIONS:

Step 1: Cut end of cable evenly. Strip cable to dimensions as shown. All cuts are to be clean and square. Do not nick center conductor when cutting. If using heat shrink tubing slide on to cable first.

Step 2: Slide spacer and pin onto cable center conductor until it yields against the cable dielectric. Solder pin in place.

Step 3: Insert the pin into the body until it yields against the back of the connector. Solder connector and cable outer conductor in place.

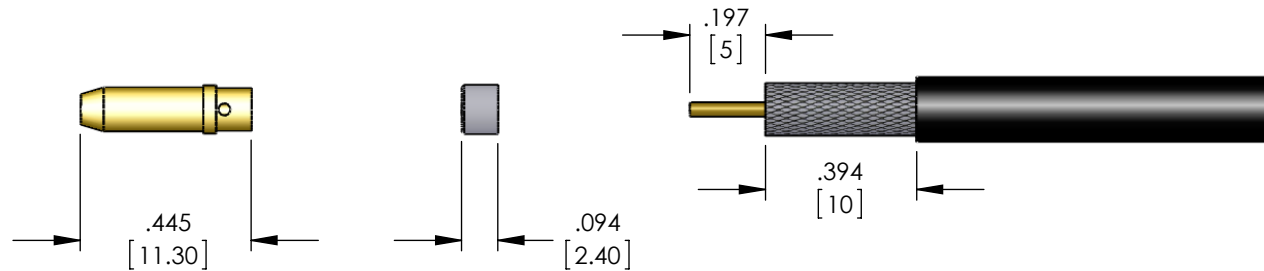
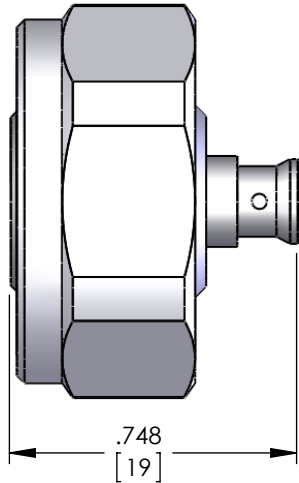

SPECIFICATIONS:

IMPEDANCE: 50 Ohms
 FREQUENCY RANGE: 0-3 GHz
 VSWR: <1.2:1 THRU 3 GHz
 INSERTION LOSS(dB): > - .1dB
 PIM: <-155dBc
 TEMPERATURE RANGE: -55°C TO 200°C
 (SR2)FOR TFT-402, .141 SEMI RIGID, RG-402/U & BELDEN 1673A CABLE

#	DESCRIPTION	QTY.	PART NUMBER	MATERIAL	FINISH
7	RETAINING RING	1	027-41M-001-CW	BeCu	WITHE BRONZE
6	SPACER	1	024-41X-001-TX	PTFE	NONE
5	O-RING	1	023-41X-001-LX	Rubber	NONE
4	4.1-9.5 SHELL	1	012-41M-001-BW	Brass	WHITE BRONZE
3	INSULATOR	1	010-41M-002-TX	PTFE	NONE
2	4.1-9.5 PIN	1	009-41M-001-BG	Brass	GOLD
1	4.1-9.5 MALE BODY	1	001-41M-001-BW	Brass	WHITE BRONZE

ROHS COMPLIANT	NAME	DATE	RF INDUSTRIES 7610 MIRAMAR RD. SAN DIEGO, CA. 92126 858-549-6340 FAX 858-549-6345	
	DRAWN	C. ZUNIGA		10/02/14
	CHECKED			
UNLESS OTHERWISE SPECIFIED:	ENG APPR.		TITLE: 4.1/9.5 PLUG, SOLDER FOR TFT-402	
DIMENSIONS ARE IN INCHES	PROPRIETARY AND CONFIDENTIAL			
ALL DIMENSIOS ARE FOR REFERENCE ONLY	THE INFORMATION CONTAINED IN THIS DRAWING IS THE SOLE PROPERTY OF RF INDUSTRIES. ANY REPRODUCTION IN PART OR AS A WHOLE WITHOUT THE WRITTEN PERMISSION OF RF INDUSTRIES IS STRICTLY PROHIBITED.		SIZE DWG. NO. REV A RFD-4195-SR2FL -	
CABLE GROUP SR2			SCALE: NTS NOTES: SHEET 1 OF 1	
CODE 001787				